

P.S.I. TIRE INFLATION

CONTROL BOX ASSEMBLY

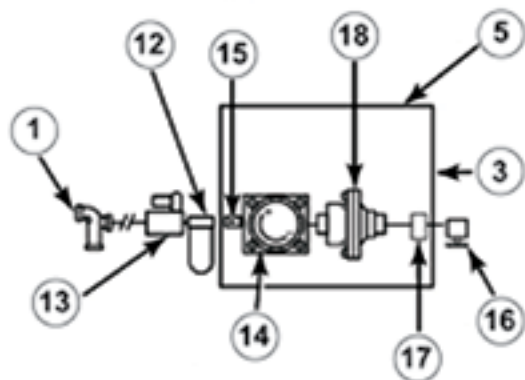

DUAL WHEEL-END ASSEMBLY

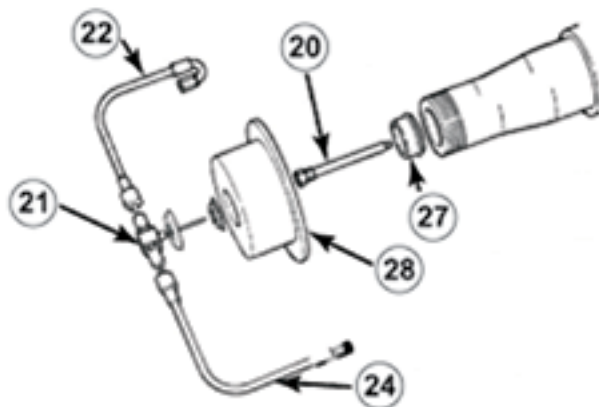

Item	Part Number	Description
1	31023-01	PRIMARY PRESSURE PROTECTION VALVE ASSEMBLY
2	311-82-70	ELECTRICAL CABLE, 70 FEET (NOT SHOWN)
3	31082-00	CONTROL BOX ASSEMBLY (INCLUDES PRIMARY IN-LINE FILTER) THERMALERT READY, REPLACES 31084-00 WHICH CANNOT BE USED ON THERMALERT SYSTEMS
4	31073-00	CONTROL BRACKET (NOT SHOWN)
5	31083-01	CONTROL BOX - EMPTY BOX, LID AND SCREWS
6	31083-28	LID ONLY (NOT SHOWN)
7	31263-06	LIGHT, BRACKET AND HARDWARE (NOT SHOWN)
8	31263-08	LIGHT AND BRACKET, NO HARDWARE (NOT FOR THERMALERT)(NOT SHOWN)
9	31263-14	LED LAMP FOR THERMALERT (NOT SHOWN)
10	31263-15	LED BRACKET FOR THERMALERT (NOT SHOWN)
11	31263-16	LED PIGTAIL FOR THERMALERT (NOT SHOWN)
12	31103-00	CONTROL BOX SELF-DRAINING FILTER
13	31083-09	CONTROL BOX SHUT-OFF VALVE
14	31083-02	CONTROL BOX PRESSURE REGULATOR VALVE
15	31114-00	CONTROL BOX BULKHEAD/CHECK VALVE
16	31083-12	DRAIN-PETCOCK
17	31084-01	BULKHEAD FITTING
18	31084-10	CONTROL BOX FLOW SENSING SWITCH
19	31313-29M	BLUE O-RING FOR THRU TEE (NOT SHOWN)
21	31314-21	10.50" STATOR AND FILTER ASSEMBLY
	31317-03	3.50" BRASS THRU TEE FOR DUAL TIRE
	31317-00	4" BRASS THRU TEE FOR DUAL TIRE
	31317-04	5" BRASS THRU TEE FOR DUAL TIRE
	31317-03-S	3.50" BRASS THRU TEE FOR SUPER SINGLE TIRE
	31317-00-S	4" BRASS THRU TEE FOR SUPER SINGLE TIRE
	31317-04-S	5" BRASS THRU TEE FOR SUPER SINGLE TIRE

Item	Part Number	Description
22	31364-00	11.50" OUTSIDE HOSE FOR WHEELS SMALLER THAN 17.50"
	31363-00	13.50" OUTSIDE HOSE FOR WHEELS LARGER THAN 17.50"
23	11342-04	VALVE CORE (NOT SHOWN)
24	31374-00	12.50" INSIDE HOSE FOR WHEELS SMALLER THAN 17.50"
	31373-00	17.00" INSIDE HOSE FOR WHEELS LARGER THAN 17.50"
25	11373-05	SEAL FOR INSIDE HOSE (NOT SHOWN)
26	31982-01	SMALL PARTS ASSORTMENT (NOT SHOWN)
27	32701-01A	PRESS PLUG KIT FOR INGERSOLL F22 AXLE
	32611-01A	PRESS PLUG KIT FOR SUDISA 11M AXLE
	32202-01A	PRESS PLUG KIT FOR MERITOR TN/TQ, HENDRICKSON HN, DANA D22 AXLE
	32342-01A	PRESS PLUG KIT FOR HOLLAND TRADE AXLE
	32473-01A	PRESS PLUG KIT FOR DANA P22, HENDRICKSON, HP AXLE (AFTER 2002)
	32184-01A	PRESS PLUG KIT FOR MERITOR TP, TB, WP, HENDRICKSON HP AXLE (AFTER 2002)
	32382-01A	PRESS PLUG KIT FOR MERITOR TB AXLE LARGE SPINDLE BORE
	61021-01A	PRESS PLUG KIT FOR MERITOR TL AXLE
	32601-01A	PRESS PLUG KIT FOR SUDISA 12R AXLE
	32321-01A	PRESS PLUG KIT FOR HOLLAND PROPAP AXLE
	32271-01	PRESS PLUG KIT FOR SUDISA 9M AXLE
	H2200-02	THERMALERT THERMAL PLUG KIT
	H2184-01	THERMALERT PRESS PLUG FOR PARALLEL SPINDLE AXLE
	H2202-01	THERMALERT PRESS PLUG FOR TAPERED SPINDLE AXLE

SEE NEXT PAGE FOR HUBCAPS ITEM# 28

P.S.I. HUBCAPS



Item	Part Number	Manufacturer	Bolt Holes	Bolt Circle	Type	Description
28	31426-00	STEMCO	6	5.50"	GREASE	STEMCO HUBCAP VERSION 4009. FOR MERITOR TN/TQ AXLES AND HENDRICKSON HN AXLES.
	OIL				STEMCO HUBCAP VERSION 4009. FOR MERITOR TN/TQ AXLES AND HENDRICKSON HN AXLES.	
				6.375"		STEMCO HUBCAP (340-4384). FOR MERITOR TL AXLES.
	31436-00		SCREW-ON		GREASE	STEMCO HUBCAP VERSION 4075. FOR MERITOR TB AXLES.
	31437-00		6	6.75"		STEMCO HUBCAP VERSION 4195. FOR MERITOR TP/WP AXLES AND HENDRICKSON HP AXLES.
	31438-00		SCREW-ON			STEMCO HUBCAP VERSION 4075. FOR MERITOR TB AXLES.
	31439-00			6.75"	OIL	STEMCO HUBCAP VERSION 4195. FOR MERITOR TP/WP AXLES AND HENDRICKSON HP AXLES.
	32273-00	DUAL DYNAMICS	6	5.50"	GREASE	DUAL DYNAMICS HUBCAP VERSION 401-G. FOR MERITOR TN/TQ AXLES AND HENDRICKSON HN AXLES.
	32283-00				OIL	DUAL DYNAMICS HUBCAP VERSION 207P6. FOR MERITOR TN/TQ AND HENDRICKSON HN AXLES.
	32293-00		SCREW-ON		GREASE	DUAL DYNAMICS HUBCAP VERSION 269G6. FOR MERITOR TB AXLES
	32295-00		SCREW-ON		OIL	DUAL DYNAMICS VERSION 267P6. FOR MERITOR TB AXLES.
	32514-00		6	6.75"	GREASE	DUAL DYNAMICS HUBCAP VERSION 456G6. FOR MERITOR TP/WP AXLES AND HENDRICKSON HP AXLES.
32515-00	OIL				DUAL DYNAMICS HUBCAP VERSION 260P6. FOR MERITOR TP/WP AXLES AND HENDRICKSON HP AXLES.	